

PROJECT NO	DRAWING NO.	REVISION
		1

COPYRIGHT AND RIGHT OF REPRODUCTION OF THIS DRAWING OR ANY PORTION THEREOF IS RESERVED BY THE ARCHITECTS

**GENERAL NOTES**

1. The Contractor is responsible for the correct setting out of the buildings and all external and internal walls with particular reference to boundaries, building lines and setting out points.
2. The Contractor is to verify all levels, heights and dimensions on site and is to check these against the drawing before putting any work in hand.
3. The Contractor is to locate and identify existing services on the site and to protect these from damage throughout the duration of the contract.
4. The Contractor is referred to the Standard Guidelines for Quality Control issued by this office for all minimum requirements for workmanship and materials. This document is to be used in conjunction with this drawing.
5. Any errors, discrepancies or omissions are to be reported to the Architect immediately.
6. Contractor is to build in Approved D.P.C.'s, whether or not these are shown on drawings to all external walls at each floor, beam or parapet level and to all windows, doors, grilles or other opening in external walls. Cavity walls to have stepped D.P.C.'s.
7. Any queries arising from all the above must be reported to the Architects for clarification before any work is put in hand.
8. Do not scale this drawing; refer to figured dimensions only.

**REVISIONS**

REV.	NAME	DATE	DESCRIPTION
0			

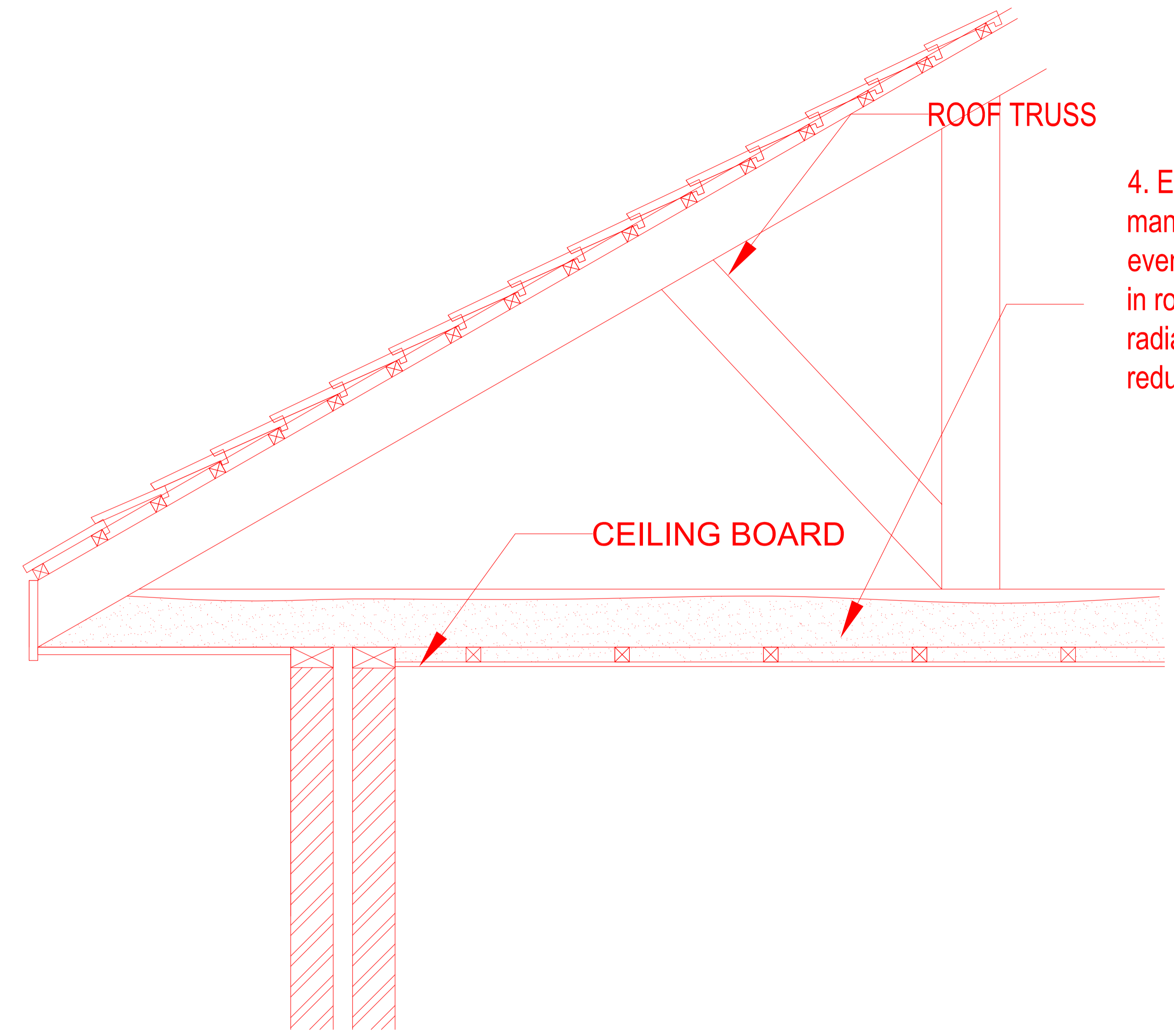

4. Eco-Insulation heavy duty lightweight cellulose fibre insulation manufactured and certified in accordance with SANS 1381-6: 2011, evenly pumped to a minimum R-value of 3.37m<sup>2</sup>.K/W) depth of 135mm in roof space above ceilings for TIASA Climatic Zone 4 (if an accompanying radiant barrier is installed the 'Deemed to Satisfy' depth requirement reduces to 100mm).

CROSS SECTION THROUGH PITCH ROOF

**PROJECT TITLE**

Eco - Insulation

**PROJECT DESCRIPTION**

Eco - Insulation product specification & installation

**DRAWING DESCRIPTION**

Eco - Insulation product specification & installation for low pitched & flat roofs for TIASA CLIMATIC ZONE 4

SCALE	1 : 50
DATE	04/02/2013
ISSUED	04/02/2013
DRAWN	DJB

**PURESPACE DESIGN**  
 10 SALT CIRCLE ARCADE  
 374 ALBERT ROAD  
 WOODSTOCK  
 016 610 9162 CELL FAX 086 616 0928  
 email: derrick@purespace.co.za web: www.purespace.co.za

Interior Design + Project Management

PROJECT NO	DRAWING NO.	REVISION
------------	-------------	----------

PS0213 PS4/213/3 0